

GUILFORD

PISCATAQUIS

RIVER

Black Stream

DOUTY

HILL

Co.

FLANDERS

ROAD

PROPERTY MAP
TOWN OF SANGERVILLE
 PISCATAQUIS COUNTY, MAINE
 PREPARED BY
JAMES W. SEWALL COMPANY OLD TOWN, MAINE
 SCALE 1 INCH = 500 ± FEET

LEGEND
 PARCEL NUMBERS 1
 ADJACENT MAPS 2
 MATCH LINE 3

For Assessment Purposes
 Not to be used for Conveyances

11/14/2018

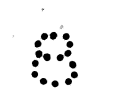

10

12

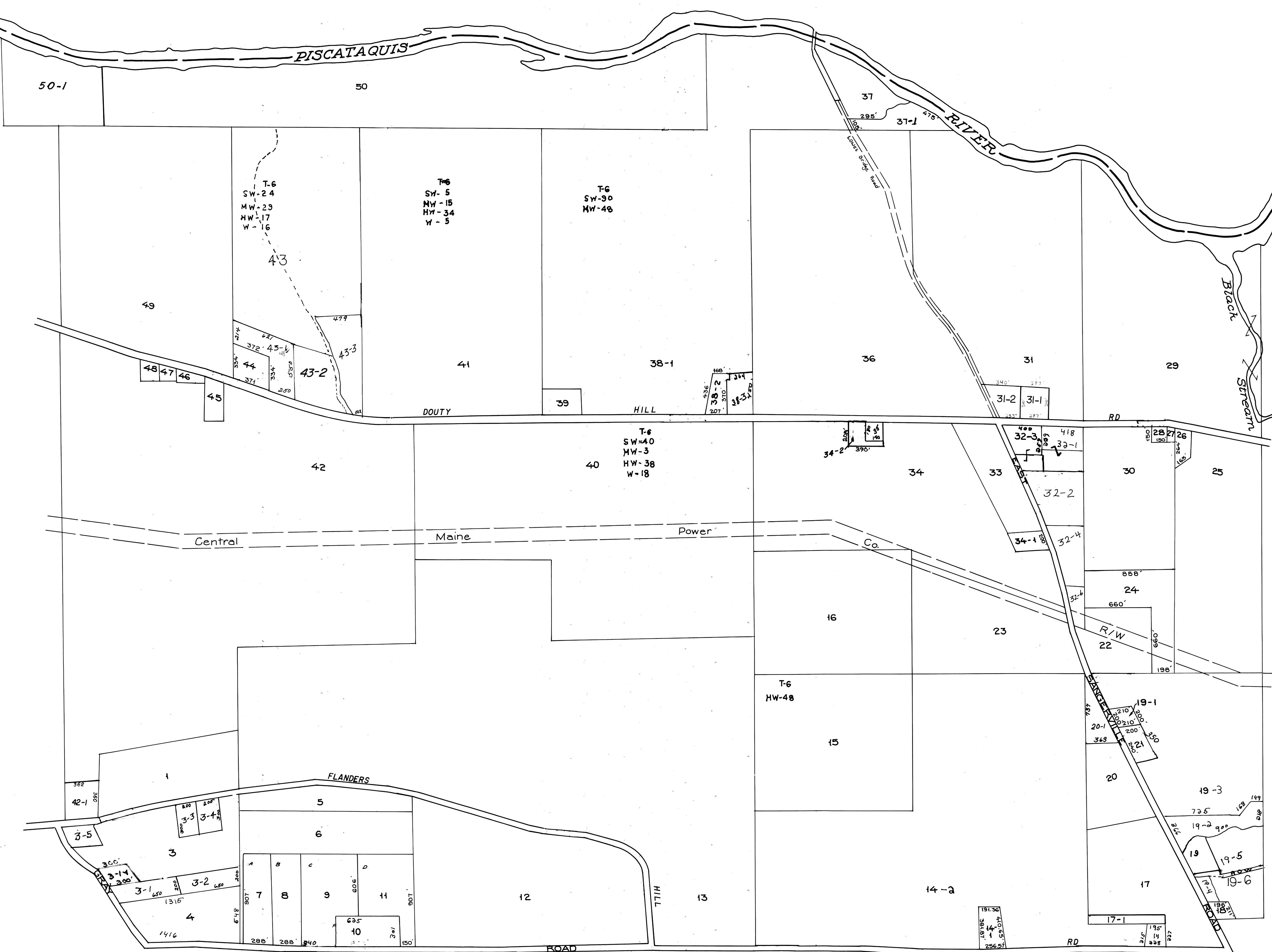

T-6
 SW-24
 MW-23
 HW-17
 W-16

T-6
 SW-5
 MW-15
 HW-34
 W-5

T-6
 SW-30
 MW-40

T-6
 SW-40
 MW-3
 HW-38
 W-18

T-6
 HW-48