

Manhanock Pond

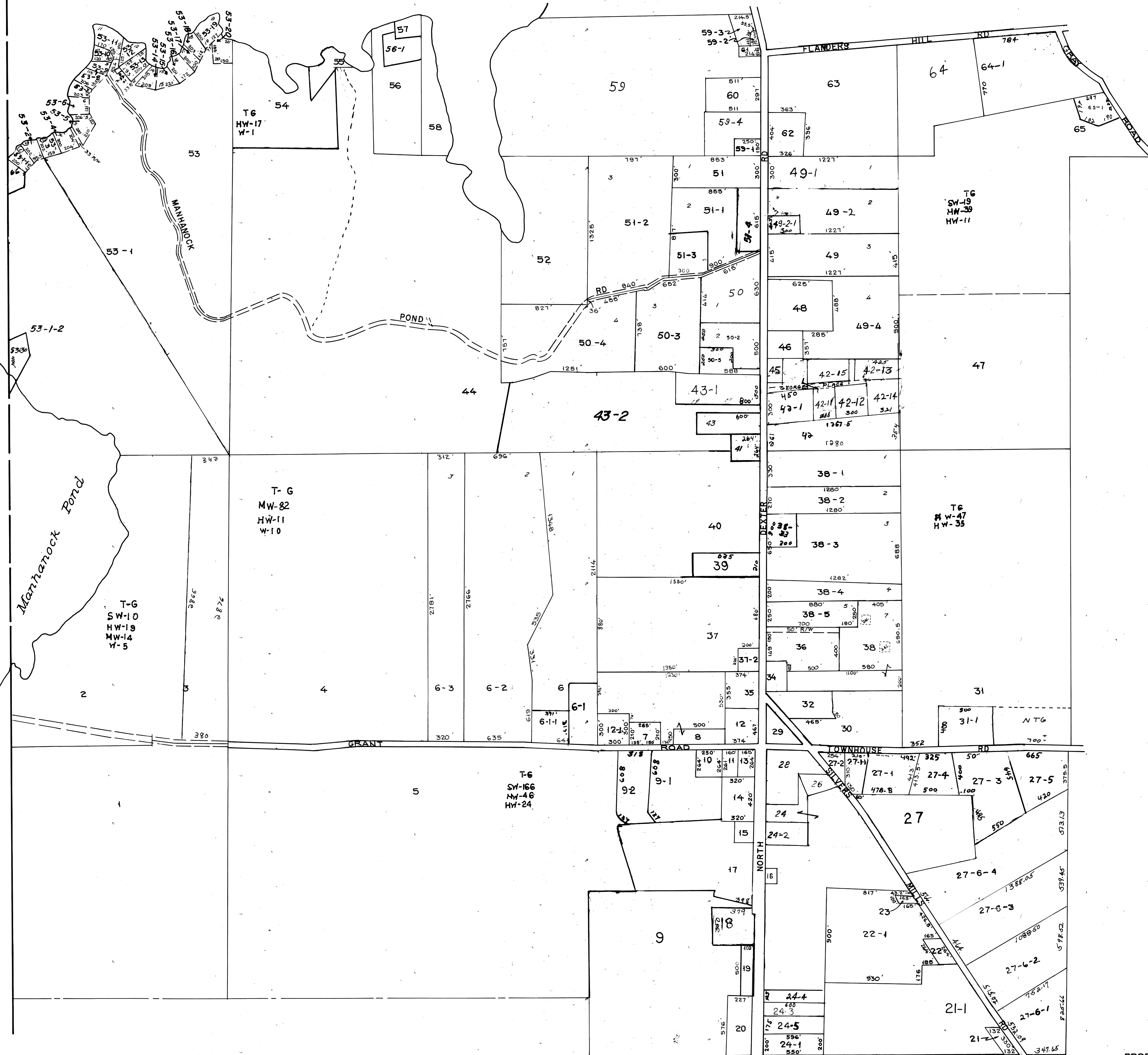

P
A
R
A
M
A
Z

Manhanock Pond

GRANT ROAD

FLANDERS HILL RD

TOWNHOUSE RD

NORTH ROAD

LEGEND

- PARCEL NUMBERS 1
- ADJACENT MAPS 2
- MATCH LINE 3

For Assessment Purposes
Not to be used for Conveyances

PROPERTY MAP
TOWN OF SANGERVILLE
PISCATAQUIS COUNTY, MAINE

PREPARED BY
JAMES W. SEWALL COMPANY OLD TOWN, MAINE
SCALE 1 INCH = 500 ± FEET